

In society and the House, everyone had their place

Class, Gender and Privacy zones

Social Order

In 19th century Queensland there was a clearly defined social order. Social position was determined by class, employment and gender.

Every role in society carried particular rights and obligations that were well understood and accepted. This applied to everyone from the governor to the lowest scullery maid and provided the security of a set of rules for each person to live by.

This social structure was reflected in the original design of the House and is still evident today.

These diagrams show the different zones within the House for various people and activities. As you move around the House you can see clues to this. Notice that the windows and doors in the front of the House are much grander than those for the servants in the rear, and how male and female bedrooms upstairs are separated by the Hall atrium and the Courtyard.

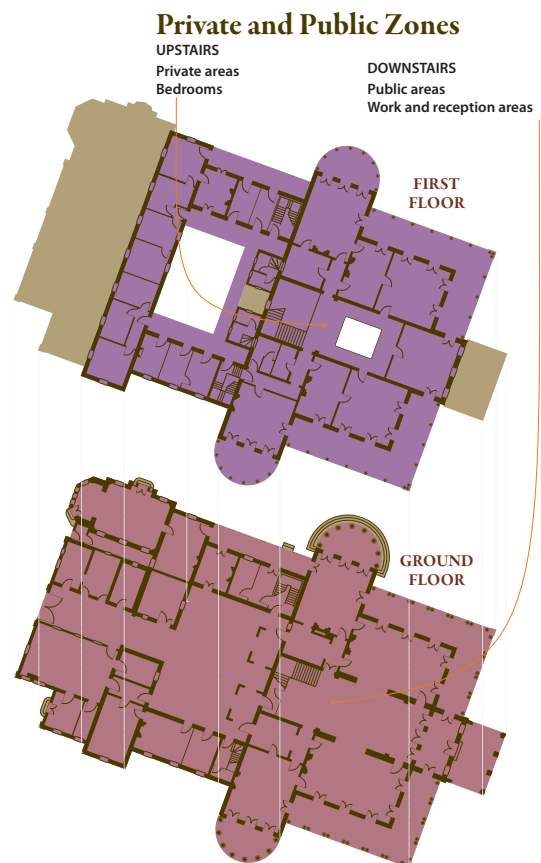
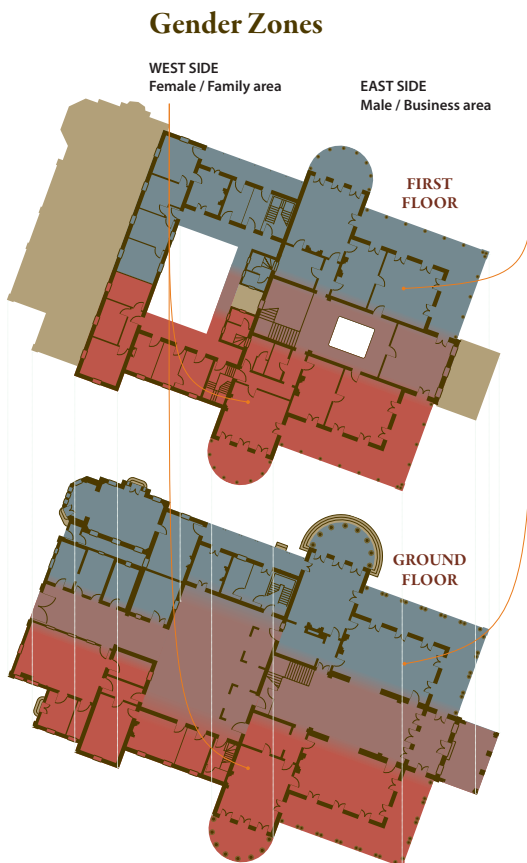
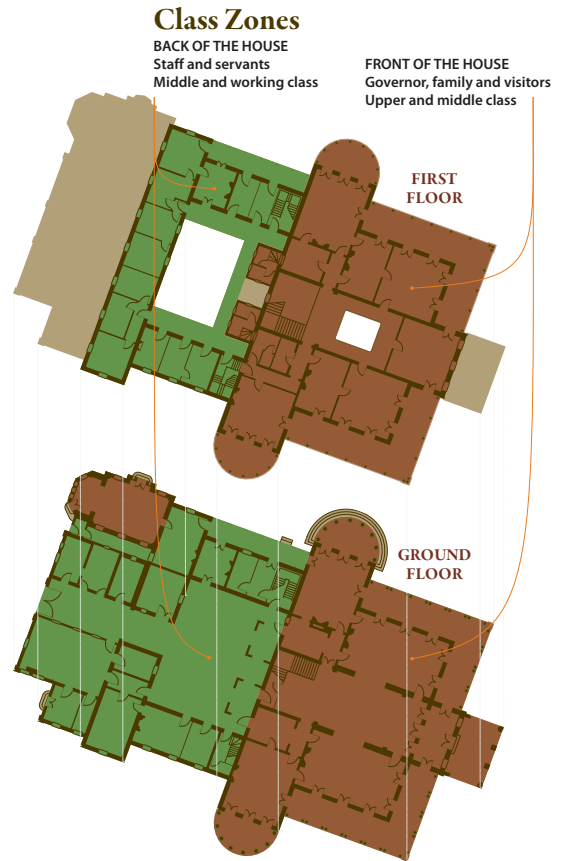

A House designed for order

Exploring the organisation of the House

Governor's Bedroom

UPPER CLASS, MALE, PRIVATE
The best private room in the House with views from the balcony over the Botanic Gardens.

Maid's Bedroom

WORKING CLASS, FEMALE, PRIVATE
Simple bedrooms for the maids who worked long hours cleaning or cooking.

Day Nursery

UPPER CLASS, FAMILY, PRIVATE
Children were 'seen and not heard'. They were cared for by a nursemaid so the room is located near the functional back of house servant's staircase.

Dining Room

UPPER CLASS, MALE, PUBLIC
In the male domain – ladies withdrew after dinner leaving the men to port and cigars. Children dined in the nursery.

Private Secretary and Aide-de-Camp's Office

MIDDLE CLASS, BUSINESS, PUBLIC
The office wing, supporting the Governor's appointments and meetings in the Library.

Kitchen

WORKING CLASS, FEMALE, PUBLIC
The cook's domain and a hub of activity from dawn till late at night.

Hall

UPPER AND MIDDLE CLASS, MALE AND FEMALE, PUBLIC
The Hall lies between the male and female domains of the House and is the place for balls and receptions. The grand staircase was never used by servants or children.

Drawing Room

UPPER CLASS, FEMALE, PUBLIC
Ladies would withdraw to the drawing room after dinner for conversation or music. The governor's wife received guests for afternoon tea here.

